

Lavender tutorial by Annie Fryd Christensen - Gypsy Boudoir Miniatures©



Materials you will need:

Wire gauge 30/32

Plier

Acrylic paint in grey, green, lavender or red and blue

Paintbrush

Tooth sticks

Wood glue or any glue that dries up clear.

Modeling sand (Alternative: lavender Flower Soft – Ultra fine)

Purple/lavender silkpaper

Mouse pad

Lycopodium

Miniature pot

Fimo or floral oasis

Modeling soil, coffee grounds or dried tea

Lavender tutorial by Annie Fryd Christensen - Gypsy Boudoir Miniatures©

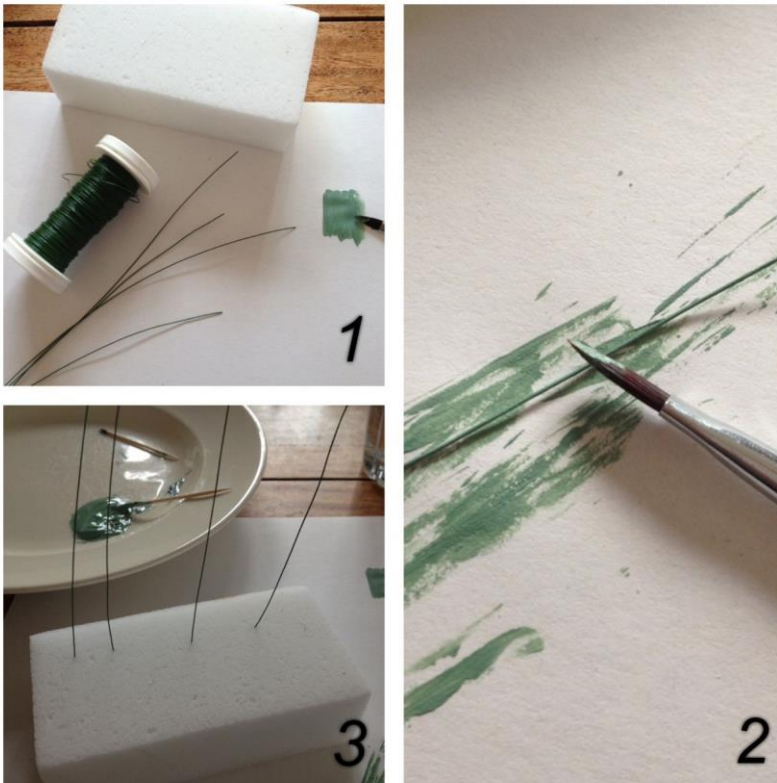

Making the stems:

I use a thin green wire (gauge 30/32) which I paint with a greyish green acrylic paint (**pic 1-2**)

You can easily mix your own color. Just remember to mix enough paint. You will need the same color for making the foliage. If you have doubt as to find the right shade of greyish green take a look at the lavenders in your garden or try Google images.

I stick the wire into a sponge to dry (**pic 3**)

When the paint has dried, cut the wire into stems at approximately 2 to 3 cm (**pic 4**)

You will need 5- 7 stems for a middle size plant. I always use an uneven number of flowers in my pots.

Flowers:

For flowers I use modeling sand. The type I use is normally used for making landscaping for model railroads. I dip 4-5 mm. of the tip of the stem in glue (I use white wood glue, it's cheap and it dries up clear) and dip in the modeling sand (**pic 5**) Leave it to dry in the sponge (**pic 6**)



Lavender tutorial by Annie Fryd Christensen - Gypsy Boudoir Miniatures©

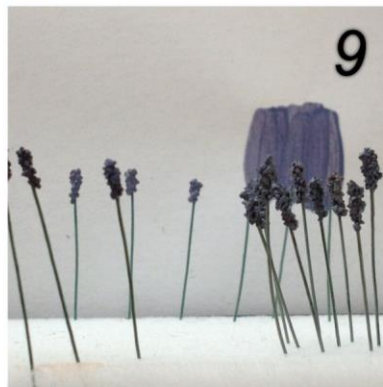
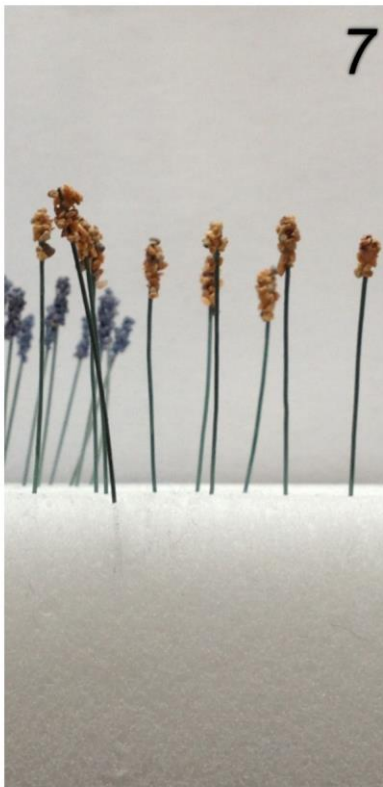

When the sand has dried you are ready for painting the lavender color **(pic 7)**

You might have the right shade of lavender, otherwise mix your blue and red acrylics into the desired color. I found very cheap acrylic paint "blue grey" and Purple grey". A mix of these gives the perfect color. I might add a tiny bit of water to dilute the paint. **(pic 8)**

Again I use the kitchen sponge to place the stems and flowers whilst drying. When the flower is painted, leave it to dry **(pic 9)**

I have a weakness for butterfly lavenders. If you do too, you can add a tiny flower at the tip of the lavender **(pic 10)**

I use a tiny star puncher and lavender silk paper **(pic 11)**

I shape the flower with a toothpick. Press with the toothpick in the middle of the star onto a mousepad or thin foam board **(pic 12)**

Glue one tiny shaped star to the top of each lavender flowers.

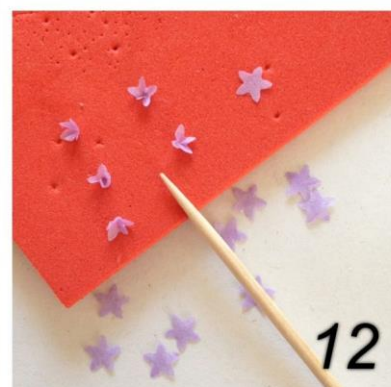
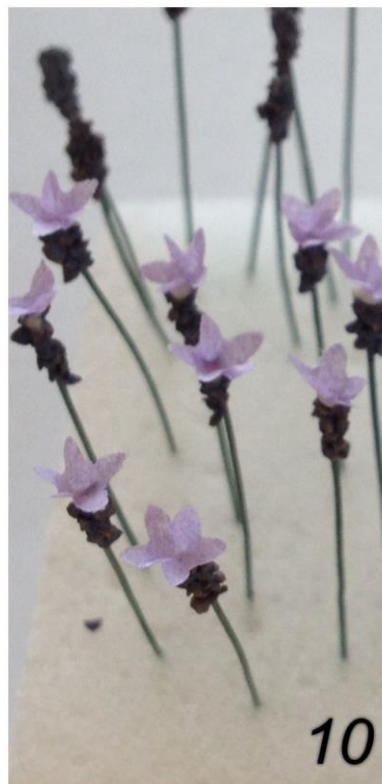

Lavender tutorial by Annie Fryd Christensen - Gypsy Boudoir Miniatures©



Foliage:

For the foliage I use Lycopodium which is a prepared green moss. Check your local flower decorater to see if you can get it there.

Lavender foliage has the same greish green color as the stems greyish. This is where you will use the mixed paint from before.

Dilute the paint a little with water that will make the paint easier to work into the Lycopodium. Paint the moss on both sides and leave it to dry.

Arranging the flower in a pot:

Now it's time to prepare your pot for potting the flower. You can use a small amount of fimo or floral oasis. I cut a small piece of oasis to fit into my pot. I glue it in place and glue before I cover with soil. **(pic 13)** For soil you can use dried coffee grounds, tea and of course modeling soil. I have used the same modeling sand as I used for flowers.

When planting I use a toothpick to make a tiny hole in the oasis. I place the foliage at first. Small pieces at approximately 1- 1.3 cm is dipped into wood glue and placed in the holes. **(pic 14)**

Now it is time to arrange the flowers. I like when the flower stems has different lengths. As mentioned I always use an uneven number of flowers. Be aware not to place the flower stems to symmetrical.

